

Sarah Venners MICEFor
svenners@fiscall.co.uk

Plan to accompany discharge of condition 7 - 09/01427/FUL - 2 Lyon Close, Abingdon

May 2013

Remove a small stretch of leyland cypress hedging along the rear boundary of the site. This can't be seen from any public vantage point, but it is preventing the establishment of the lawn through shading and moisture abstraction and it would be more appropriate to be able to establish a herbaceous border along this boundary to enhance the attractiveness of the garden. This hedge is not visually attractive and is devoid of wildlife value. A herbaceous border will provide an important nectar source for flying insects which the leyland cypress cannot do.

Remove G5 - two pollarded horse chestnut trees. The two horse chestnuts are of poor form and have been topped heavily at approximately 3m, resulting in severe decline. Decay is prevalent within the trunk at old pruning points and as the trees are adjacent to a public footpath as well as a lawn, there is a risk of persons being harmed by falling branches as they decay further. The surface of the public footpath is also being lifted dangerously as a result of tree roots emanating from these trees - which is a future trip hazard for users of the footpath. It is considered that no remedial work could improve their longevity.

Plant one new birch tree in the corner of the garden to add structure and form to the garden and mitigate for the loss of the vegetation to be removed.

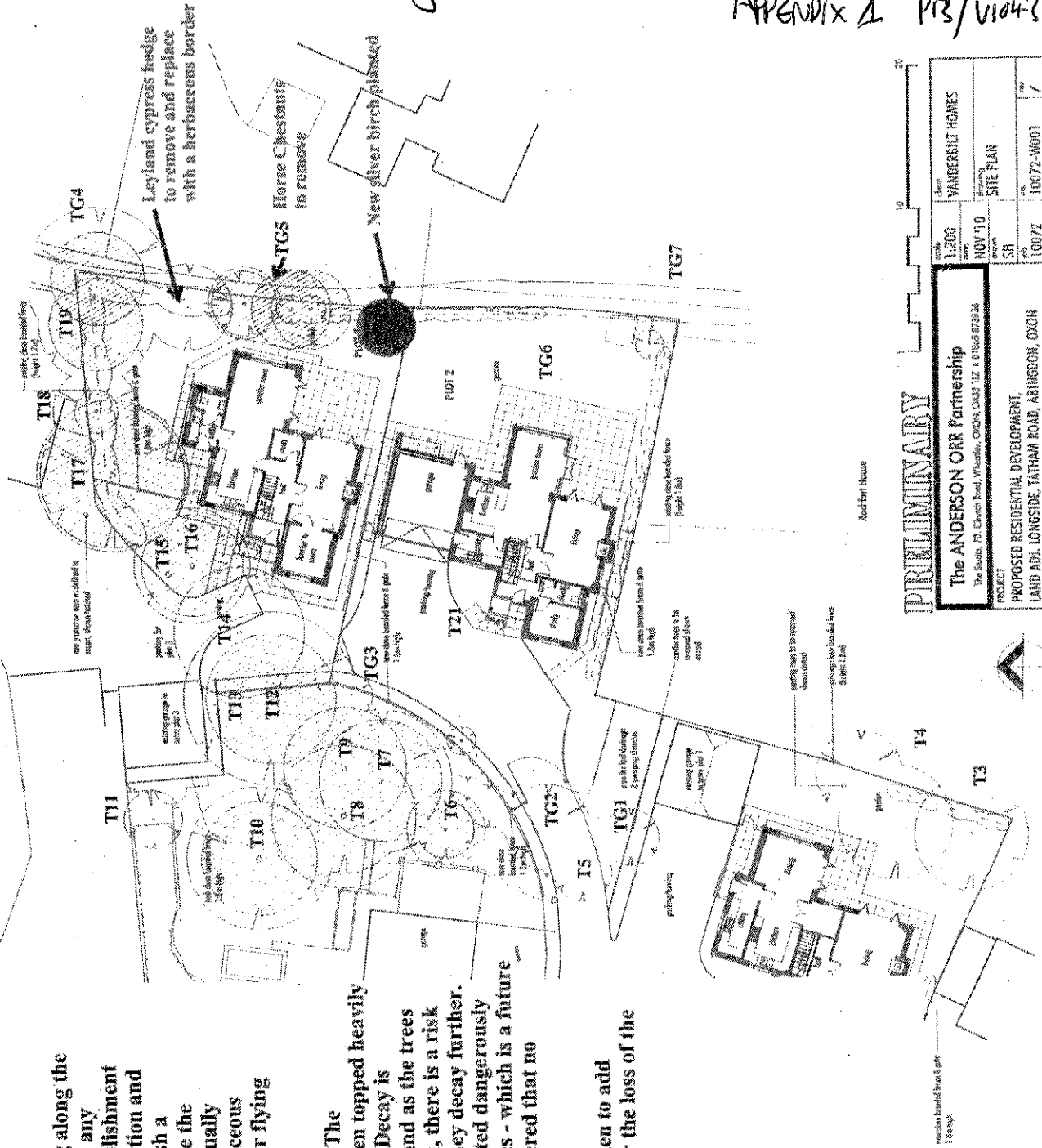

Notes:
All measurements are to be checked on site and not relied upon for planting.
This is a preliminary plan and is subject to change. It is intended for use by the Planning Department and should not be used for any other purpose.
Regulations:
For use in reverse normal location only.
Copyright reserved

PRELIMINARY		The ANDERSON ORR Partnership		VARDESBILT HOMES	
The Studio, 10, Clarendon Road, Whiteley, COX43 1JZ & 10, BUCKLETON ROAD, COX43 1JZ		DATE: NOV '10		DRAWN: SH	
PROJECT		NO: 10072		NO: 10072-WB001	
PROPOSED RESIDENTIAL DEVELOPMENT, LAND ADJ. LONGSIDE, TATHAM ROAD, ABINGDON, OX43					

2 Lyon Close

APPENDIX 1 PR3/VI043/FUL

May 2013
 Sarah Yenners MFCFor
 syenners@fiscali.co.uk

Revised Landscape plan to accord with variation of Condition 7 - 09/VI/427 Revision 1 - 18 June 2013

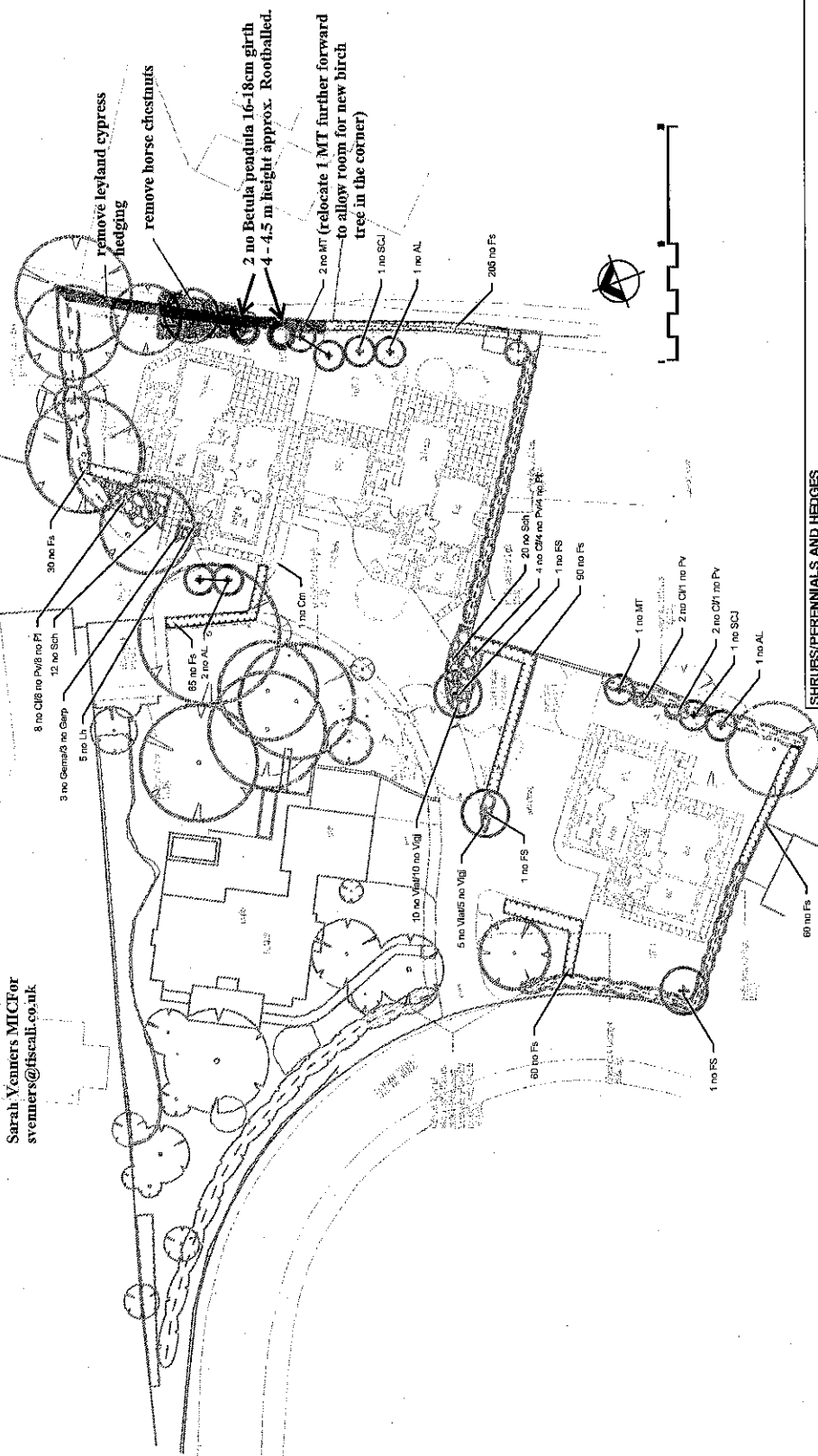

LEGEND

	Existing trees to be retained. Existing heights maintained at not less than 2m height, except where within sight line.
	Existing vegetation removed
	Proposed trees
	Proposed hedge planting, to be maintained at not less than 2m height.
	Proposed shrub planting
	Proposed climbing plant

NOTE
 For details of existing trees see Sarah Yenners Arboricultural Report dated January 2011.

DATE
 JANUARY 2011

SCALE
 1:200 @ A1

CONSULTANT
 Amanda Hopwood Landscape Consultancy
 Assessment & History & Design & Interpretation & Management
 Shaker Oak Farm, Halesley, St. Wilfrid, Devon OX26 5JX
 Tel: 01362 818728 email: amanda.hopwood@aleholic.co.uk

CLIENT
 VANDERBILT HOMES

PROJECT
 LAND ADJACENT TO LONGSIDE,
 TATHAM ROAD, ABINGDON

DRAWING TITLE
 PLANTING PLAN

DWG NO
 1101.1

SHRUBS/PERENNIALS AND HEDGES

SHRUBS/PERENNIALS PLANTED AT DENSITIES SHOWN IN 450MM DEPTH APPROVED TOPSOIL WITH COMPOST/FERTILISER ADDED AS SPECIFIED, AND WITH MIN 50MM DEPTH APPROVED BARK MULCH FINISH. SUPPLY 3 NO 3M LONG STRAINED WIRES TO FENCE TO SUPPORT CLEMATIS.

CODE ON DWG	NAME	FORM/AGE/ CONDITION	SEV SHOOTS	ROOT COND/ CONT SIZE	MIN NO BREAKS	PLANTS/M2	TOTAL NO
Cm	CLEMATIS MONTANA RUBENS	BRANCHED	BRANCHED	C 2L	2	N/A	1
Cl	COTONEASTER LACTEUS	BRANCHED	BRANCHED	C 3L	4	3	12
Fs	FAGUS SYLVATICA	TRANS 1+2	TRANS 1+2	BAGGED		SILIN M	510
Gema	GERANIUM MACRORRHIZUM 'ALBUM'	VEG	VEG	C 2L		4	3
Gepp	GERANIUM RIVERSLEMANUM 'RUSSELL PRITCHARD'	VEG	VEG	C 2L		4	3
Lh	LAVANDULA HIDCOTE'	BUSHY	BUSHY	20-30 C 3L	5	4	5
Pv	PHILADELPHUS 'VIRGINAL'	BRANCHED	BRANCHED	60-80 C 3L	4	3	12
Pt	PRUNUS LUSITANICA	BRANCHED	BRANCHED	80-100 C 10L	6	3	12
Sch	SYMPHORICARPOS X CHENAUILLI	BRANCHED	BRANCHED	40-60 C 3L	5	4	32
Vat	VINCAMINOR ATROPURPUREA	BUSHY	BUSHY	20-30D C 1.5-2L		5	15
Vaj	VINCAMINOR GERTRUDE JEKYLL	BUSHY	BUSHY	20-30D C 1.5-2L		5	15

TREES

EHS TREES PLANTED IN POSITIONS SHOWN ON PLAN IN 1000 X 1000 X 900MM DEEP PITS BACKFILLED WITH APPROVED TOPSOIL/COMPOST/FERTILISER MIX AS SPECIFIED, SUPPORTED BY 2 NO 75MM DIAM 1.8M LONG STAKES WITH BELTING AS SPECIFIED. OTHER TREES PLANTED IN POSITIONS SHOWN ON PLAN IN 600 X 600 X 450MM DEEP PITS BACKFILLED WITH APPROVED TOPSOIL/COMPOST/FERTILISER MIXTURE AS SPECIFIED, SUPPORTED BY 2 NO 50MM DIAM 1M LONG STAKES WITH BELTING AS SPECIFIED. SYRINGA SPP DO NOT NEED STAKING. ALL NATIVE TREES TO BE OF BRITISH PROVENANCE.

CODE ON DWG	NAME	FORM/AGE/ COND	GIRTH/OVERALL HT (CMS)	CLEAR STEM	ROOT COND/ CONT SIZE	MIN NO BREAKS/ BRANCHES	TOTAL NOS
AL	AVELANCHIER LAMARCKII	MULTI STEMS X	200-250 HT	N/A	BAGGED	3	4
FS	FAGUS SYLVATICA	EH 3X	16-18/MIN 450	MIN 200	ROOTBALLED	5	3
MT	MYLIUS TRILOBATA	HS 3X	12-14/350-425	175-200	ROOTBALLED	5	3
SCJ	SYRINGA CHARLES JOLY	BRANCHED	60-80	N/A	ROOTBALLED	3	2